



Welcome, Winter!

Edgewater Neighborhood Association | Winter Newsletter 2019 - 2020



RockfordEdgewater.org
rockfordedgewater@gmail.com
 PO Box 515, Rockford, 61105

Neighborhood Association Officers

President & Alderman
 John Beck 815.289.4787
john.beck@rockfordil.gov

Vice President
 Michelle Bowman

Treasurer
 Mark Podemski

Secretary
 B.J. Alexis

Board Members

Barb Berman
 Dick Berman
 Stacy Bernardi
 Michael Goddard
 Phyllis Holm
 Kim Millhorn
 Bill Simpson
 Jennifer Smith

Community Services Officer

Brian Squires
 779.500.6627
brian.squires@rockfordil.gov

Edgewater Neighborhood: Such a GREAT Place to Call Home!

We are so excited to share this Winter 2019—2020 Newsletter with you!

If you received this newsletter, you are a resident in the Edgewater Neighborhood. The boundaries for Edgewater are Auburn on the South, North Main on the West, the Rock River to the East, and the railroad tracks to the North. These boundaries are pictured in the map on the outside of this newsletter.

Edgewater includes approximately 1,200 households, both single family homes as well as multi-family dwellings, and every household is welcome to become a member of the Edgewater Neighborhood Association. The association has been active since 1979, and continues to organize neighborhood activities and advocate on behalf of Edgewater residents to this day. Membership is voluntary, \$20 per year per household.

Your membership helps support neighborhood activities (such as the Easter Egg Hunt, 4th of July, Luminaria, and the Holiday Party) and your additional donations provide funds to pay for alley snowplowing — the City of Rockford does not plow alleys, so Edgewater pools our resources to pay as a whole neighborhood for that service.

In the past couple of years, we have worked to increase engagement and camaraderie among neighbors. We developed a new website, increased communication through social media, and changed the annual holiday party format to be more welcoming to families and neighbors from all corners of Edgewater. We feel that these efforts have been successful! However, over the years membership in the Edgewater Neighborhood Association has decreased. This, combined with a hard winter last year that drained our snow plow fund, mean that finances are not as strong as we would like them to be. You can see a breakdown of the Association revenue and expense from 2019 on page 3.

We believe that Edgewater is a stronger and more vibrant neighborhood because of the work of our neighborhood association. For the Association to remain strong, we depend on your membership! As we approach our annual Membership Drive (learn more on page 2) we encourage you to renew your membership for 2020 or sign up for the first time. Thank you in advance for helping ensure the Association can continue working to keep Edgewater a place we can feel proud to call home.

We hope you enjoy the wealth of information and updates included in this newsletter, and that you'll extend your thanks and patronage to the businesses and organizations which have advertised within!

Happy Holidays to you and your family from the
 Edgewater Neighborhood Association Board!



Edgewater Events

December 7: Edgewater Membership Drive & Luminary Sale

9 a.m. - 4 p.m. on Saturday, December 7, buy your affordably priced bags and candles for this year's Luminaria at Village Green, 2640 N. Main. Bring your own container and also pick up free sand.

During the sale, renew your Edgewater Membership for 2020 or join up for the very first time; the annually-renewable \$20 per-household membership supports Edgewater events. Additional donations may be made to support our neighborhood snow plow fund—remember, Edgewater Neighborhood Association pays for alley clearing all winter long! Payments can be made by cash, check, or card during the sale, by using the form on page 14 of this newsletter, or online at rockfordedgewater.org



December 14: Luminaria!

All neighbors are warmly encouraged to participate in an Edgewater tradition: Luminaria! Line your walkways with luminaries (white candle-lit bags weighted with sand) at dusk on Saturday, December 14. If you plan to host a holiday party this is a great night to do it!

Volunteers will also set up and light hundreds of luminaries in common areas such as the Auburn Street Bridge; want to help? Call John Beck at 815.289.4787.



Volunteers load hundreds of luminaries on a trailer, destination Auburn St. Bridge!



December 18: Edgewater Holiday Party

Wednesday, December 18, join us for an evening of food, fun, and fellowship! Enjoy heavy appetizers, games, live music, and prizes. This is a family-friendly event -- there will be crafts and games for kids, and Santa will be on hand to hear their wishes from 5:30 - 7:30! New for 2019—bid on fantastic items in a silent auction! All proceeds support Edgewater Neighborhood Association.

We are very grateful to the Rockford Country Club for again hosting our party and for their longstanding support of our neighborhood.

All Edgewater residents of all faiths and traditions are warmly welcome. We look forward to celebrating with you!

Adults: \$20 (pre-register) \$25 (walk-in)
Children 4 - 18: \$5 Children 0 - 3: Free!

REGISTER by FRIDAY, DECEMBER 13, online at RockfordEdgewater.org/events
(offline payment options are available)

****COUNTRY CLUB MEMBERS:** Edgewater is managing payment for this event. Please note your membership on the online event registration form; we will provide Member names to RCC so the cost can be applied to your account**



News from the Neighborhood Association

Edgewater Neighborhood Association: Profit and Loss for 2019

To the right you will find a profit and loss statement for the Association, detailing income and expense incurred from November 2018 to November 2019.

A couple of key points to note:

1. Snowplow expense for Winter 2018 - 2019 exceeded snowplow donations during the same timeframe. Remember, the City of Rockford does not plow Edgewater's alleys, so as a neighborhood we pool our resources to pay for the entire neighborhood's alleys to be plowed. The prior two year's lighter winters had built up a reserve that covered the deficit in 2018 - 2019, but we need to build the fund back up to ensure we have the resources to plow Edgewater's alleys throughout the winter of 2019 - 2020.
2. Each Special Event does make some income, but that income does not cover the cost of the events. Membership Dues cover the difference for each event. The Holiday Party is the most expensive event Edgewater puts on. Three years ago the format of that event was changed to be more welcoming to families and neighbors from all corners of Edgewater. This effort has been a great success, with attendance exceeding 130 people in 2018 and much greater diversity of Edgewater residents represented. In order to keep offering this lively, welcoming event we will need to increase Membership Dues to cover the difference between income and expense.

While Edgewater Neighborhood Association still has a positive balance in our bank account, we know that without increasing the number of households that participate in Membership and donate to the Snow Plow Fund it will become increasingly difficult to offer the events, activities, and advocacy that have been offered in the past.

Whether you've been a Member since 1979 (when the Association was founded!), were once a Member and have let your membership lapse, or have never chosen to become a member, we ask that you join us in Membership for 2020! There are lots of ways to become a Member:

- * Attend the Membership Drive and Luminary Sale in person on December 7th (full details on page 2!)
- * Use the form on page 14 of this newsletter
- * Pay online on the neighborhood website:
rockfordedgewater.org

If you have any questions about this Profit and Loss report or about the Association in general, email us at rockfordedgewater@gmail.com

Thank you in advance for your Membership!



Edgewater Neighborhood Association Profit and Loss

12 month rolling report as of November 21, 2019

	Total
Income	
Membership Dues	2,910.00
Snowplow Donations	2,244.00
Newsletter Ads	1,361.00
Special Events	
- 4th of July Event	272.75
- Christmas Event	1,514.63
- Easter Event	165.00
Other Income	1,367.50
Total Income	9,834.88
Expenses	
Newsletter Expense	1,448.08
Snowplowing Expense	3,530.00
Special Event Expenses	
- 4th of July Event Expense	509.83
- Christmas Event Expense	4,011.11
- Easter Event Expense	427.71
Neighborhood Maintenance	590.00
Other Expenses	2,154.30
Total Expenses	12,671.03

Net Income (2,836.15)

For Housing News, Visit: Edgewater-Homes.com



Keith Kelly

815-509-3655

keithk@dickersonnieman.com

News Near the Neighborhood

SwedishAmerican to open Edgewater Medical Clinic in early 2020

It was just over one year ago when SwedishAmerican broke ground for construction of a new clinic just up the street from our neighborhood. The brand new Edgewater Medical Clinic is complete, and the facility will be furnished, stocked, and fully staffed in time for its grand opening, planned for Monday, January 13, 2020! In advance of this opening, the community is invited to attend a **Community Open House on Saturday, January 11, 2020, from 10 a.m. to noon.** The public is welcome to tour the space and meet some of the providers, as well as enjoy refreshments, balloon animals, and meet the Caring Canines and members of the Rockford Fire Department. The clinic is located at 2909 N. Main Street.



Breaking ground November 7, 2018.

Grace Funeral & Cremation Services opens new facility

It's always exciting to have new businesses move into the neighborhood (or nearby!) and coming up on January 15th you're invited to attend the open house and ribbon cutting for Grace Funeral & Cremation Services new space at 4301 N. Main Street! Formerly the Moose Lodge, the building has been repurposed to include rental event space, a funeral home, crematory, and pet crematory. **Their open house and ribbon cutting will be January 15th from 3-6 pm, and people are also welcome to stop by for information and tours any time!** Here are a few Before and After photos from the newly renovated interior, learn more and find their contact information: gracefh.com



At left: Top, Before: Moose Lodge bar. Bottom, After: Grace Funeral Home Coffee Bar.

At right: Top, Before: Moose Lodge lobby. Bottom, After: Grace Funeral Home lobby.



COYLE KILEY
INSURANCE AGENCY, INC.



CoyleKiley – With You Every Step of the Way.

C·K

810 North Alpine Road · Rockford, Illinois 61107
815-987-2170 · Fax 815-987-9862 · www.coylekiley.com



Doors Open in January!

Edgewater
Medical Center

At Swedes we understand you and are here for you.

Because after all, we're close like family which is why we're growing for the community!

Edgewater Medical Center will be a beautiful facility providing primary care, obstetrics and so much more.

We can't wait to serve the Edgewater community.

For more information or to find a doctor that's right for you, visit SwedishAmerican.org.

SWEDISHAMERICAN
A DIVISION OF UW HEALTH

Coming soon at 2909 N. Main Street | Rockford, Illinois

Community Events (continued on page 8)



All Aglow at Nicholas Conservatory & Gardens

See the sparking holiday lights in the outdoor gardens and floral displays inside the conservatory from November 29 - January 6.

In addition to the OUTDOOR displays, Saturdays and Sundays from December 1 - 15 book your ticket for the All Aglow Express! Trolley Car 36 transforms into a holiday train. Tickets must be purchased in advance — call the All Aglow Express phone hotline to reserve your space and for all details: 815-987-8858.

In addition to the INDOOR light displays, enjoy live holiday music performed by local musicians. Performances are included with paid admission to the Conservatory on select dates in December.

Visit www.nicholasconservatory.com/all-aglow/ for hours, admission, and all other details.

Festival of Lights at Sinnissippi Park

Pack the car with family and friends and enjoy the 30th-annual Festival of Lights! The display is open Friday - Sunday, 6-10 p.m., from November 29 to December 30, as well as 24-hours a day on Christmas Eve and Christmas Day, and 5p-12 a.m. on New Year's Eve.

TWENTY new displays have been added for this 30th season!

Santa will be appearing every weekend from 7 - 9 p.m.; children will be able to place their letters to Santa in a special red mailbox — be sure to include your return address to hear back from the elves, and no postage is required! Admission is free, donations are accepted.



Swedish Christmas: Lucia Concert, Julmarknad, Glogg & Pepparkakor Party

Erlander Home Museum and Swedish Historical Society host a series of Swedish holiday events this season, starting with traditional Lucia concert on Friday, December 6, at First Lutheran Church, 225 S. 3rd Street. The next morning, continue the holiday spirit with Julmarknad, held at Our Savior's Lutheran Church! Enjoy breakfast with Tomten (reservations required) and shop the Marknad for holiday gifts all day long. On December 11, celebrate at the Glogg & Pepparkakor Party held at the new Nordic Cultural Center. Visit swedishhistorical.com/events for details and tickets.



The Nutcracker Ballet

The beloved ballet returns to the Coronado Performing Arts Center as the Rockford Dance Company performs this holiday classic with professional lead dancers. The music of Tchaikovsky is performed by the Rockford Symphony Orchestra. Performances Saturday, December 7, 7:30 pm and Saturday, December 8, 3:00pm. Visit rockfordsymphony.com/2019-2020-season for details and tickets.



The Norwegian Snømarket

The Norwegian restaurant is celebrating its ONE YEAR ANNIVERSARY with an outdoor winter market, including holiday foods, hot cider, and glögg, as well as handmade pottery, clothing, wood carvings, and more from our favorite local makers. Kids will be able to decorate ornaments for a good cause and have their picture taken with a yeti! This event will take place behind the restaurant, 1402 N.

Main St. Warming stations will be located inside the restaurant. December 14 and 15, 3 - 9 p.m. each day.



Your Neighborhood Yoga Studio.

Healing Centered
Community Inspired
Accessible Wellness

Offering Yoga, Reiki & Wellness Workshops

Check out our class schedule at
thecalm.com/company/classes

Saturday Classes Now Available!

1404 N. Main St. Suite 3 Rockford, IL 61103
Located above the Norwegian Restaurant.

2715 N MAIN ST.
ROCKFORD IL 61103

P: (815)964-8713

F: (815)964-3719

rockfordfamilydental@gmail.com



CATHERINE M. BAER-MIRZA DDS
Razvan C Mirza DDS

www.rockfordfamilydental.com

Consider the Rockford Family Dental Membership Plan in 2020!

Dr. Baer-Mirza and Dr. Mirza created the Rockford Family Dental Membership Plan to help patients in their office that did not have insurance. The plan offers reduced fees on all dental procedures at their office located at 2715 N. Main Street.

Starting January 1st, 2020 the plan will offer more benefits to loyal members. The Plan will cost \$10.00 per month per member and runs from January 1st to December 31st, 2020. The membership fee includes 1 Exam, 6 intraoral radiographs and 2 adult/child healthy mouth cleanings per year. Each member will receive a member packet which will include the member plan fee schedule, a membership card and an explanation on how the plan works.

The fee schedule included in the member packet describes the reduced fees offered at Rockford Family Dental's office at 2715 N. Main Street. Members receive between 20% - 45% reduction from regular fees. There is no annual maximum and no annual deductible. There is an additional 5% discount if the balance for dental services is paid in full by cash or check the same day as the service is received.

There are two ways to pay for 2020 Membership:

1. Onetime payment of \$120.00 in January 2020; or
2. Two payments of \$70 in the consecutive months of January 2020 and February 2020.

Stop by the office at 2715 N. Main Street or call 815-964-8713 to learn more!

Happy Holidays!

Dr. Baer-Mirza and Dr. Mirza



Community Events, Continued



Historical Holidays: Ethnic Heritage Museum & Tinker Swiss Cottage

Sunday, December 8, from 12 - 4 p.m. see how the six galleries celebrate the Christmas holiday season at Ethnic Heritage Museum,

view English holiday traditions at the Graham-Ginestra House, and experience Victorian Christmas Traditions at Tinker Swiss Cottage. Visit EthnicHeritageMuseum.org or TinkerCottage.org for details.



Holiday Hoopla & Countdown to FUN at Discovery Center

December 26 - 30, from 11 - 3. get your gray matter in gear while you wander this drop-in workshop space. LEGOs are just the beginning of what you can use to build it bigger. Use real tools to create using recycled materials, and take what you make!

New Year's Eve from 12 - 4, Design a party hat, create a noise maker, and get showered with confetti as we count down to midnight each hour. Ring in the New Year with our STEAM-y blend of science, technology, engineering, art, math, and fun! Included in the price of admission. Visit DiscoveryCenterMuseum.org for more details.

Olympic Tavern Events

THE OLYMPIC TAVERN

The holiday season means a FULL calendar at Olympic Tavern:

- * December 4: Titos Holiday Smash
- * December 5: Rockford Crawl Drink and Draw / Krampus Art Show
- * December 14: Ugly Sweater Party
- * December 14: Luminaria
- * December 20: There Will be Darkness 9 - Winter Solstice & Dark Beer Festival
- * December 24: Customer Appreciation & Christmas Party
- * December 27: New Year's Weekend 2019

Check out all the details for these events at OlympicTavern.com



Village Green

2640 N Main St.
Rockford, IL 61103
(815) 877-7027

Thank you for
supporting our
North Main St location!

6101 E Riverside Blvd
Rockford, IL 61109
(815) 877-9559

www.villagegreenrockford.com

Locally owned for over 50 YEARS!

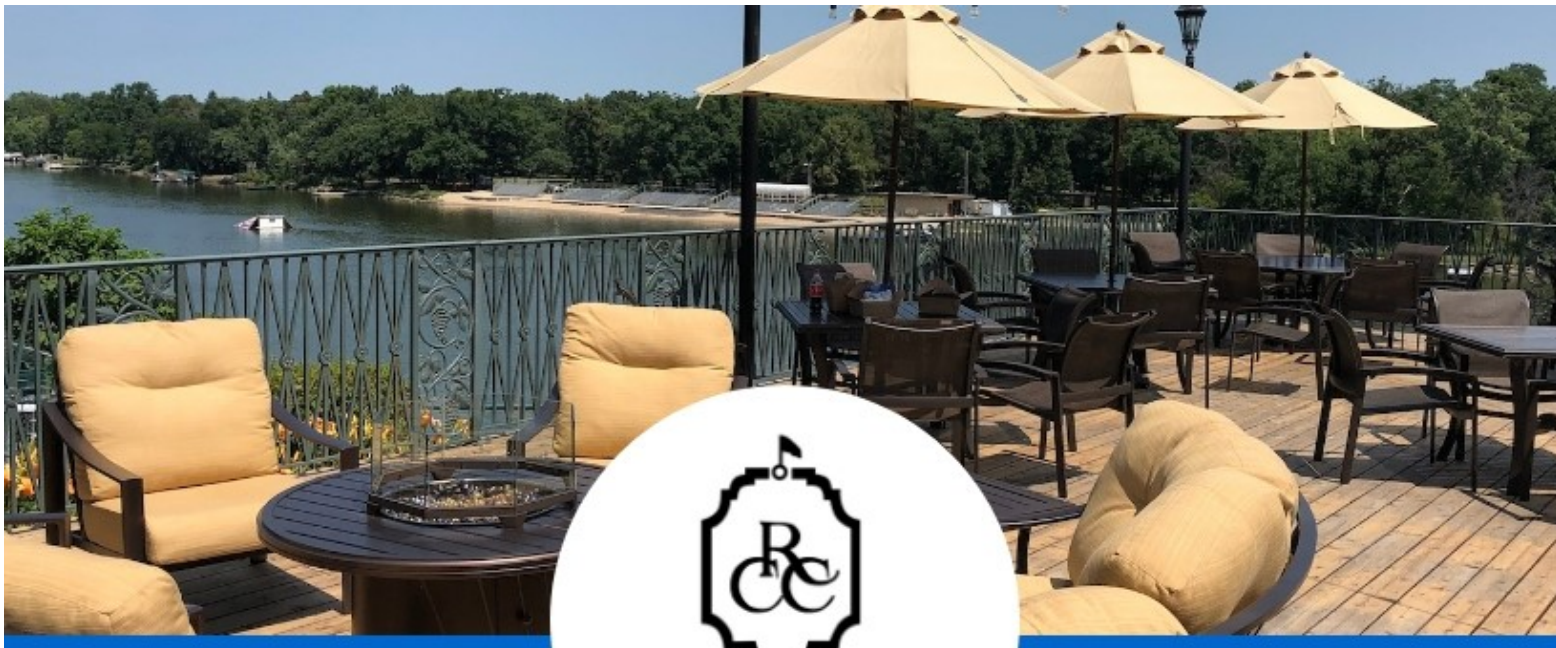

ROCKFORD COUNTRY CLUB

A PROUD MEMBER OF THE EDGEWATER NEIGHBORHOOD SINCE 1889

Rockford Country Club offers the perfect one-year memberships to preview everything we have to offer. Golf Preview Membership allows unlimited family access to golf, pool, tennis, skeet, dining, and social events. Social Preview Membership allows unlimited family access to the pool, tennis, skeet, dining, and social events.

CALL FOR YOUR PERSONALIZED TOUR TODAY!

2500 Oxford Street www.rockfordcc.com 815.968.9881



Seasonal Reminders



Yard Refuse Pickup

Yard refuse pickup will continue through the week of **December 2nd**, and occurs on the same day your trash is picked up. Refuse including leaves, grass, and sticks should be placed in compostable brown paper yard waste bags or in garbage cans that are clearly marked with an "X" on all sides. Branches may be no more than 4 inches in diameter, should be trimmed to 4 feet in length, no bundle of branches or yard waste bag or can should weigh more than 50 pounds. **Reminder:** Bagged trash and yard refuse should not be placed in the street for pickup but up on the right of way or driveway so street sweepers can get closer to the curb. Sweeping crews do not come back to sweep an area that was missed because of improperly placed garbage receptacles or parked cars.

Reminder: it is illegal to blow, rake, or sweep yard refuse into the street. This is not only unsightly but also clogs gutters, storm drains, and puts unnecessary debris into our water system.



Cold Mornings = Seasonal Opportunity for Car Theft

Every year when the temperature drops, it can be very tempting to leave your car running and unattended, to warm up before the drive to work, school, or errands. This leads to another sort of temptation, for enterprising thieves watching for empty, running cars! This year the Rockford Police Department released a funny meme to raise awareness about this serious problem. Never



leave your car running and unattended, even for a few minutes. The cold isn't pleasant but having your car stolen is WAY more unpleasant!



HELPFUL NUMBERS:

SNOW HOTLINE:
779-348-7260

GRAFFITI HOTLINE:
779-348-7261

NEIGHBORHOOD
STANDARDS HOTLINE:
779-348-7395

POLICE NON-EMERGENCY
NUMBER: 815-966-2900

WINNEBAGO COUNTY
ANIMAL CONTROL:
815-319-4100



Lifelong Edgewater Resident!

**J. Hanley for Winnebago
County State's Attorney**

**VOTE EARLY, or
on March 17th**

Paid for by Friends of J. Hanley



Seasonal Reminders



Help Keep Edgewater Walkable All Year: Keep Sidewalks Clear!

As long as the snow flies, please keep sidewalks as clear of snow and ice as possible. If you live on a corner, do your best to keep the path from the sidewalk to the street clear; this is not always an easy task but your efforts ensure pedestrians and pups have safe passage year round.

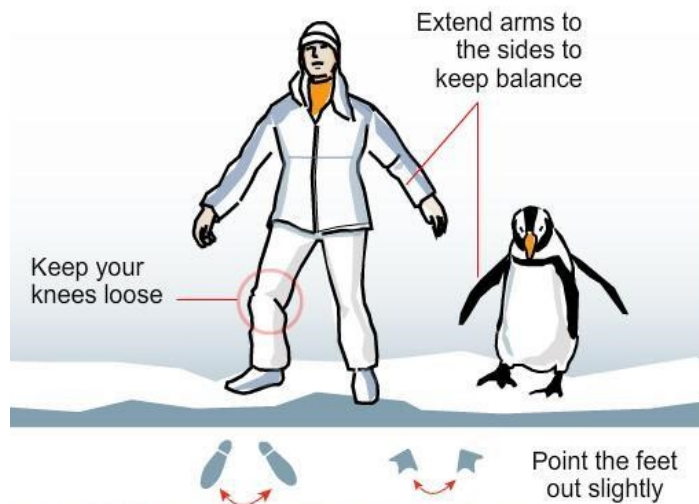

When Winter Walking take Extra Care!

When you're out there enjoying Luminaria or any other sparkling winter night, take EXTRA care to avoid falls and injuries if snow and ice are a factor. Remember the penguin and their careful, tottering steps — it may feel a little silly but remember, safety first!

Winter Parking & Snow Clearing Reminders

Odd/Even parking is always in effect always during a declared Snow Emergency to assist with snow clearing operations. **Vehicles must be parked on the side of the street with odd-numbered addresses on odd-numbered days and on the side with even-numbered addresses on even-numbered days by 8:00am (for example, on Dec. 9 you'd park on the odd side of the street by 8:00am).**

If your street is marked as "No Parking" on one side, a Snow Emergency declaration allows you to park legally in the restricted area during the time the Snow Emergency is in effect. **Do not assume that you can move your car when the street is plowed, it must remain parked appropriately until the Snow Emergency is lifted.** Your cooperation is greatly appreciated as it ensures Edgewater streets are thoroughly cleared after every storm. Call the Snow Hotline at 779-348-7260 with any questions.

Edgewater contracts with a private company to have all the alleys in the neighborhood plowed. The contractor is called into plow to after 2 inches of snow have fallen. **Payment for the contractor comes from Edgewater membership dues and additional donations to the snow plow fund. Join us for the Membership Drive on December 7 (see page 2 for more details), use the membership sign up form in this newsletter, or visit rockfordedgewater.org to pay online!**



DO-IT-YOURSELF DOG WASH AT PAMPERED PET GROOMING

NW CORNER OF RIVERSIDE BLVD. AND N. MAIN ST.

\$12.00 for ½ hour and \$20.00 for an hour.

Includes brushes and combs, towels, power dryer, walk-in tube and aprons.

You can use our shampoo for \$1.00 extra or bring your own.



Goes by appointment,
please call 815-282-9663.



Additional News & Notes

Illinois Snow Sculpting Competition returns to Sinnissippi Park for a 34th Season!

Teams from across the state will travel to Rockford on January 22-25, 2020, for the 34th annual Illinois Snow Sculpting Competition! The Rockford Park District hosts this very special winter event. Teams spend the weekend sculpting snow into beautiful, unique, and totally temporary creations! Drive or walk through the park daily during the event until 10:30 p.m.

If the winter does not provide enough snow naturally, never fear! Snow machines will be utilized to provide enough material for all of the teams! However, should the event be postponed due to weather conditions, it will be held February 5-8, 2020.

Be sure to add this unique event to your calendar, and visit ILSnowSculpting.com to learn more!



King Kong and the Empire State Building, carved into snow!

City of Rockford offers Two New Communication Tools

The City of Rockford is publishing a monthly Community Newsletter to share updates of all kinds, including performance updates from the Police and Fire Departments, notable economic development projects, and other seasonal and timely updates. Visit rockfordil.gov and look for the "Newsletter Sign-Up" link.

Need to report a pothole, graffiti, weeds violation, or a traffic signal outage? Submit the information through the online Service Request Portal! Visit <https://dp.rockfordil.gov/DPRresponsive/PortalAccount/Login>

Call in Potholes before Winter Sets In!

Before the winter weather really hits the stateline, crews are out in full force working on pothole repairs. Potholes are prioritized based on their severity, daily traffic count and speed limit of the road. To report a specific pothole, please call 779-348-7260.



What's the Difference Between a 911 Call Log and Police Statistics?

This example illustrates the difference between the two. If someone calls 911 and needs a Fire/EMS response, it goes into the internal 911 System Dispatch Log as a "Medical Call" to alert our fire department (ambulance) to respond. If the call also requires a police response, like a stabbing, a gunshot or an overdose, then it goes into our internal system as an associated "Medical Assist" to alert the police department to respond to assist the fire department. That information ensures we send the right teams to respond to the crisis.

Information in the 911 Dispatch Log is NOT used in our monthly statistics. The monthly crime statistics are auto-generated based off the formal police reports that are written during and after an incident. The police reports include appropriate coding to identify the actual crime that has occurred. Those same statistics are also reported to the FBI. The FBI has conducted random audits of our police reports and statistics since 2006 and has awarded the police department high marks for accurate reporting.



A look into Edgewater's past...

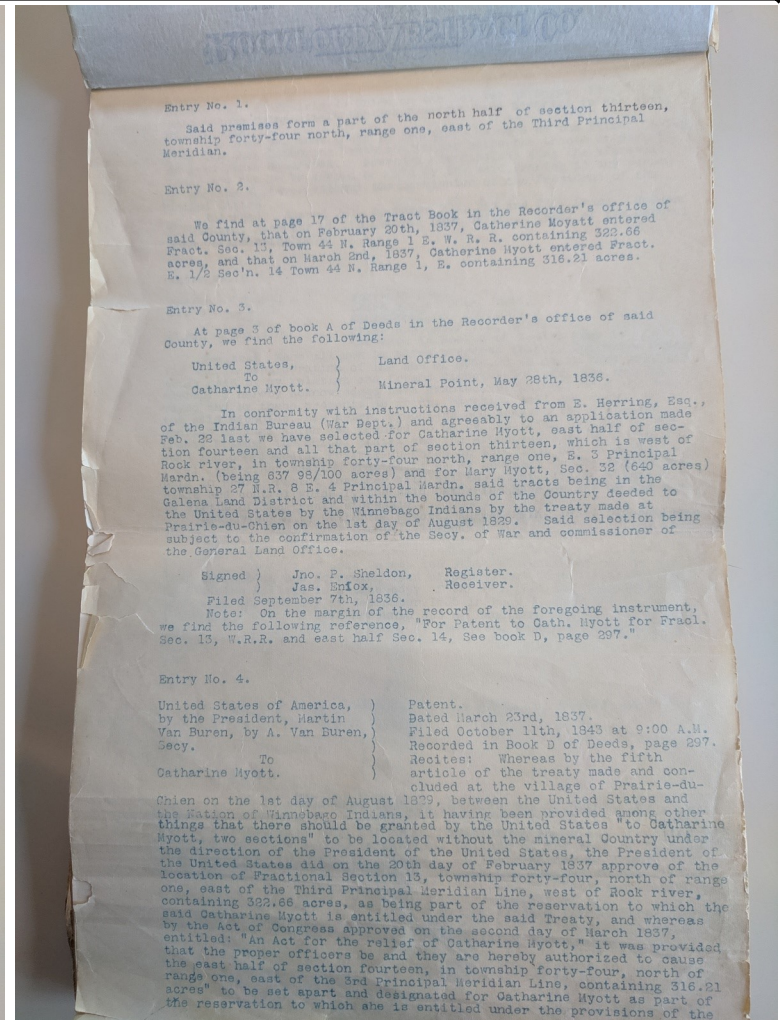

Getting a glimpse back (WAY back!) in time thanks to a thoughtful neighbor

Edgewater residents living on Clinton Street received a unique gift from some neighbors who had moved out — the abstract book for the neighbor's former house on Clinton Street between Camlin and Ellis, with records dating back to May 1836! Pictured above at left is the cover of the book, including the Rockford Abstract Company logo on top, their RAC stamp at bottom left, and a sketch of the block that includes the property in question.

Pictured above on the right is the first page of entries in the abstract book, detailing the first records of the land tracts that included this property on what is today Clinton Street. Those first entries occurred in the late 1830s, and detailed the land transfers that were made to members of the Nation of Winnebago Indians following a treaty between the tribe and the United States government in 1829. The land that we now know as Edgewater was part of the land transferred to Catherine Myott, member of the Nation of Winnebago Indians, under the authority of President Martin Van Buren. You may recognize the name Myott — there is still a street named Myott in Churchills Grove.

Over time, the original partial land "sections" that were deeded to Catherine Myott were sold, subdivided, platted, and developed. The story of these changes where they relate to this specific property on Clinton Street are all documents in this abstract book. It's a unique artifact with a special story to tell, and we are very fortunate that the Edgewater neighbors who currently possess the book are willing to share it with us all! **At our monthly Edgewater Neighborhood Association Meeting in April 2020, these neighbors will bring the book and give a presentation about its contents. We hope you will join us on April 15, 2020, 5:30 p.m. at the Rockford Country Club for what will be a one-of-a-kind opportunity to learn more about this place we call home! Please plan to attend!**

Do you have a unique or historic Edgewater artifact that you'd be willing to share (in picture form or otherwise) with the neighborhood? Please let us know! Email Edgewater Neighborhood Association at rockfordedgewater@gmail.com

Set the stage for Edgewater's Future!

Become a Member of the Edgewater Neighborhood Association!

The Edgewater Neighborhood Association was established in 1979 to promote a sense of community and provide resources that help keep Edgewater a beautiful, safe, and inviting place to live. Your annually-renewable \$20 Membership dues support:

- ❖ Snow Plow Fund: The City does not plow Edgewater's many alleys, so as a neighborhood we pool our resources and contract with a plow service to keep those alleys clear all winter long.
- ❖ Seasonal Neighborhood Activities including the Easter Egg Hunt, Annual Garage Sale, 4th of July Festivities in Oxford Park, the Holiday Party, and Luminaria (including Luminaries placed in public places like the Auburn Street Bridge).
- ❖ Watering planters on Auburn Street and the north side of Auburn Street Bridge.
- ❖ Postage for neighborhood mailings and printing of those mailings, as well as signs advertising neighborhood activities.

Thank you for your Membership and for helping Edgewater continue to be the vibrant, unique neighborhood we can be proud to call home!



Please mail your completed form with check (made out to Edgewater Neighborhood Association) to:

Edgewater Neighborhood Association
PO Box 515
Rockford, IL 61105

Prefer to pay by card?

Pay online with PayPal at www.rockfordedgewater.org!

Name _____

Address _____
(Used for Edgewater mailings)

Phone _____
(Used for Edgewater information only)

Email _____
(For updates from Alderman & Neighborhood Association President, John Beck)

Membership Dues **\$20**

Additional Donation _____
(to support snow removal and other neighborhood activities)

TOTAL _____

Submit your Edgewater photos and show off the best views from our neighborhood!

We need your help! We're looking to expand our collection of Edgewater photos, taken by Edgewater neighbors, showing off all the things you love about our neighborhood. Submissions will be used in future newsletters, on Facebook, and on our website. Photos from all seasons welcome! Email your photos (JPG or PNG, please) to rockfordedgewater@gmail.com. Thank you!

Please Note: by submitting a photo, you give us permission to use it as described above, and also indicate that any people in the photos have given permission to be featured on those platforms, too. We reserve the right to crop/edit photos. Submission does not guarantee that a photo will be used.

Pictured at right: Clinton Place lampposts in snowstorm



Promote your business to Edgewater neighbors!

Run an ad in the Edgewater newsletter and reach hundreds of neighbors in Edgewater and beyond! Digital newsletters are emailed to over 400 residents and posted on Facebook, NextDoor, and the neighborhood website. Physical newsletters are also mailed to 1200 Edgewater households in the fall. All proceeds support the Edgewater Neighborhood Association. Ad materials (PDF, JPG or PNG files) can be submitted to rockfordedgewater@gmail.com. Please contact us with any questions!

PRICING: Digital (spring, summer, fall) -- Full-page ads are \$100, 1/2 page \$50, 1/4 page \$25, business card size \$20.

Print (winter) — Full-page ads are \$140, 1/2 page \$75, 1/4 page \$40, business card size \$30.



A Little Holiday Fun!

Guess the Christmas Carol!

Put on your thinking caps and have some fun guessing what Christmas Carols each of these unique phrases is describing! Think you've figured them all out and want to check your work? Visit rockfordedgewater.org and look for the "Christmas Carol Guessing Game" link on the homepage to get all the answers!



Mayor's Holiday Card Winner!

WE HAVE A WINNER: After careful deliberation, judges have selected the artwork that will appear on Mayor Tom McNamara's Holiday Card. Congratulations to Roman Gorsline, a seventh grader at St. Rita's. His artwork features many iconic Rockford symbols, including our own Fred VanVleet. Thank you to all of the young artists who submitted entries, and thank you to the judges: Curator/Executive Director at Rockford Art Museum Carrie Johnson, Artist and Co-director of 317 Art Collective Jenny Mathews, and Hip-hop artist Vic Rivera - for combing through more than 130 works of art. Stay tuned for an announcement on where you will be able to see all of the artwork on display in December.



1. The apartment of 2 psychiatrists
2. The lad is a diminutive percussionist
3. Decorate the entryways
4. Sir Lancelot with laryngitis
5. A B C D E F G H I J K M N O P Q R S T U V W X Y Z
6. Wanted in December: top forward incisors
7. The smog-less bewitching hour arrived.
8. Exuberation to this orb.
9. 288 Yuletide hours.
10. Do you perceive the same longitudinal pressure which stimulates my auditory sense organs.
11. Stepping on the pad cover.
12. Far back in a hay bin.
13. Leave and do an elevated broadcast
14. Listen, the winged heavenly messengers are proclaiming tunefully.
15. Frozen precipitation commence
16. We are Kong, Lear and Not Cole
17. Oh, member of the round table with missing areas
18. Boulder of the tinkling metal spheres
19. Vehicular homicide was committed on Dad's mom by a precipitous darling
20. Cup-shaped instruments fashioned of a whitish metallic element
21. Our fervent hope is that you thoroughly enjoy your yuletide season
22. May the Deity bestow an absence of fatigue to mild male humans.
23. Assemble everyone who believes.
24. Obese personification fabricated of compressed mounds of minute crystals.
25. I spied my maternal parent osculating a red-coated, unshaven teamster.

Recognize an Edgewater Neighbor for doing something GREAT!

Here's an opportunity to anonymously recognize Edgewater neighbors for all the GOOD things you see them doing! Notice a neighbor making an improvement to their house or yard? Doing something to make our neighborhood more welcoming, beautiful, safe, or fun? Click the "Great Job, Neighbor" icon on the homepage of rockfordedgewater.org and send us their contact information — even if you only know their address, we'll get a thank you in the mail from the Edgewater Neighborhood Association to let them know their good deed was noticed!

Great Job,
Neighbor!



Edgewater Neighborhood
Association
P.O. Box 515
Rockford, IL 61105

To our Edgewater Neighbors at:

*Here's your Winter 2019-2020
Edgewater Newsletter! Check out
updates about neighborhood events
and much, much more inside!*



Hello, Edgewater Neighbor!

We are so excited to share this Winter 2019 - 2020 Newsletter with you!

If you received this newsletter, you are a resident in the Edgewater Neighborhood. There are nearly 1,200 households located in the Edgewater Neighborhood.

The boundaries for Edgewater are Auburn on the South, North Main on the West, the Rock River to the East, and the railroad tracks to the North. These boundaries are pictured in the map to the right.

We hope you enjoy the wealth of information and updates included in this newsletter, and that you'll consider becoming an Edgewater Neighborhood Association Member for 2020! Learn more about what Membership supports (including snow plowing Edgewater's alleys!) inside.

Happy Holidays to you and your family from the
Edgewater Neighborhood Association!

